

RUNWAY GUARD LIGHT

Elevated Light – High Intensity – Unidirectional

EL 220



EL 228-TCB (Wig-Wag)

Runway and Taxiway

Features

- low energy consumption
- prefocussed halogen lamp PK30d, with above-average life expectancy
- power supply through a compact flash trigger unit
- compact design
- optical housing sturdy and tight (IP67)
- no optical adjustments after maintenance and light unit replacements
- smooth outer glass surface
- quick-release locking device with hinge, no loose parts
- complete with frangible pedestal and base plate
- connection to 6.6A series circuit or 230V AC power supply

General

Runway Guard Light system EL 228-TCB (Wig-Wag) is designed in accordance with ICAO Annex 14, 5.3.20 for use in configuration A as elevated marking of runway/taxiway intersections associated with a runway.

Intended for use during reduced runway visual range conditions. Serving as a warning to pilots approaching a runway hold position and an active runway.

Guard Light system includes pair of elevated, unidirectional light fittings fixed to supporting console. Alternating yellow flash is controlled by a flash trigger unit (flash rate approx. 0,7 cps).

Installation (system with two flash units)

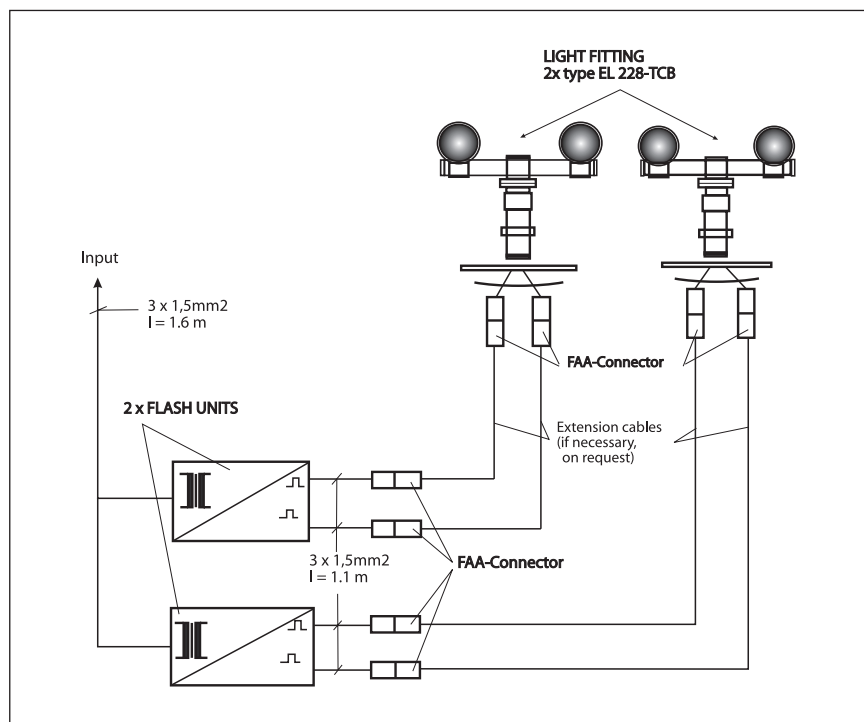

Description

Flash Unit

Designed as a safety transformer with built-in electronic flash generator. Unit is in a watertight housing (IP 68).

Cable for primary power input and secondary cables for each fitting are made of high quality material. Flash unit installation directly into the ground.

Input cable connections are sealed with heat shrinkable tubes.

Flash unit will be connected to 6.6A series circuit or 230 V AC power supply.

Light Fittings

Each Guard Light has two independent standard ERNI light fixtures with uni-directional projector light (yellow light beam).

Installed visor above each light reduces the amount of incident sunlight glare on the lens. Enhancing the contrast between the on and off state of the Runway Guard Lights.

The supporting console is equipped with a breakable coupling and designed for 2"/11.5 NPS mounting.

Each Guard Light is individually adjustable for toe-in and elevation.

Light characteristics and performance (100 W/6.6A)

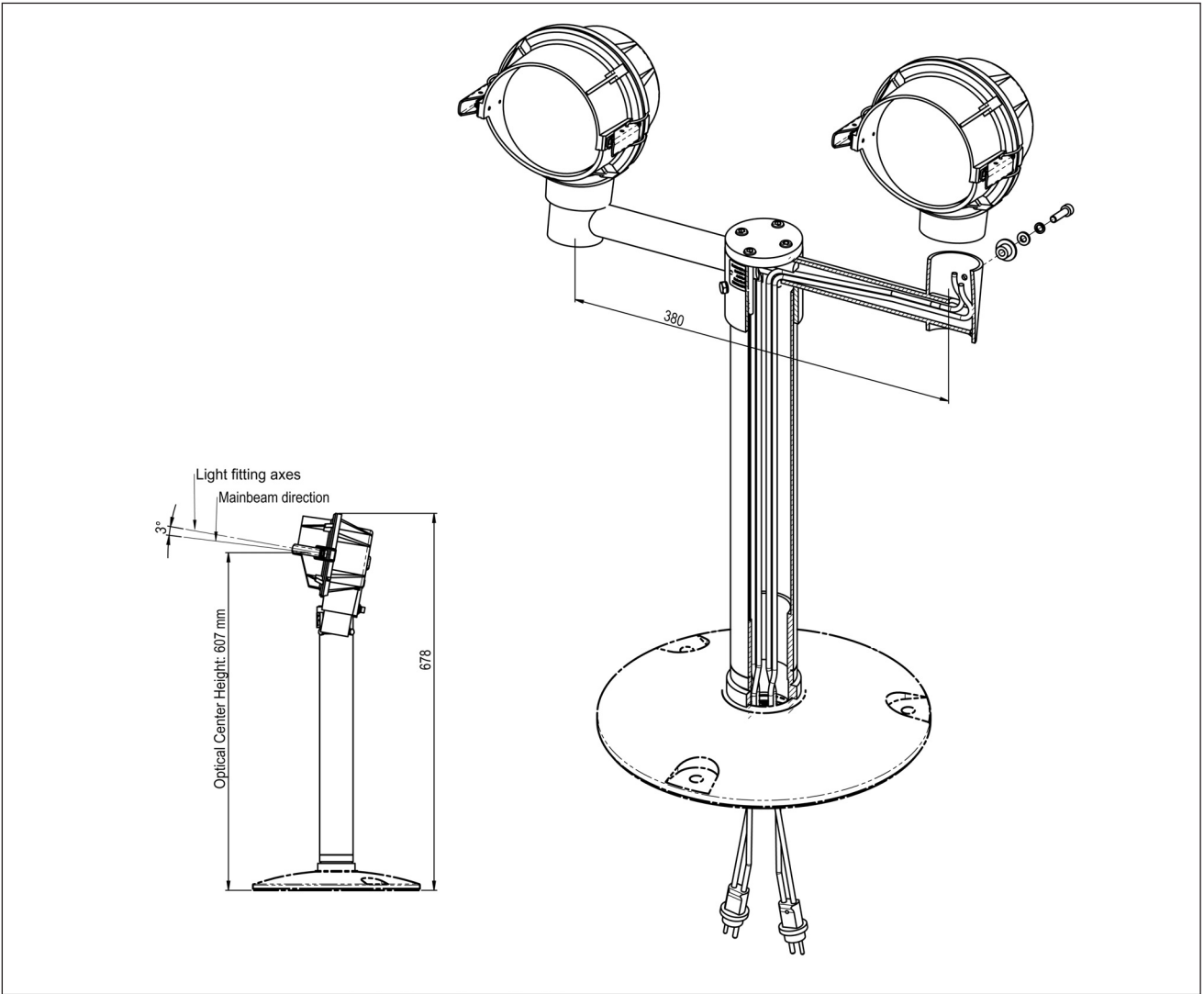
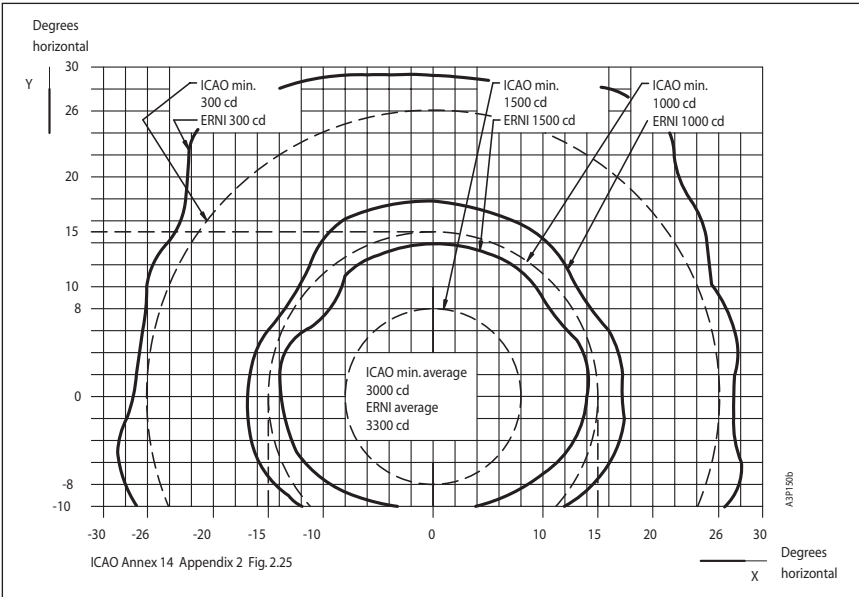

Technical Parameters

- horizontal spacing of pair of lights 381 mm
- optical height – standard supply 600 mm
- vertical settings 0° – 20°
- horizontal settings 0° – 360°

Dimensions/Weights

Article	Weight	Packing (cardboard box)
EL 228-TCB including console	4,6 kg	480 x 550 x 310 mm
Base Plate	2,4 kg	315 x 315 x 60 mm
Flash trigger unit including cables	6,0 kg	170 x 120 x 120 mm

Options

- flash trigger unit for 220–240V input or 6.6A series circuit
- lamp rating from 45 W/6.6A to 200 W/6.6A

Accessories

- extension cables
- substructures
- leveling device (Adjustment Jig)

Accessories must be ordered separately.
For details see also section «mounting systems».

Subject to change