

## TAXIWAY/APRON

**IL 254D**

**8"**

**LED Inset Light – Low Intensity – Omnidirectional**



### **IL 254D-AGM**

Aircraft stand manoeuvring guidance (Apron), Apron edge

### **IL 254D-REL**

Low intensity runway edge Runway circling guidance

### **L 254D-TEL**

Taxiway edge

## General

The lights of series IL 254D meet the guidelines of Annex 14 as well as Part 4 of the Aerodrome Design Manual and are in compliance with IEC 61827. They are suitable as edge lights on taxiway and apron as well as for manoeuvring guidance on aircraft stands and heliports.

LED lights are characterized by their low energy consumption and extremely reduced necessity of lamp changes. Lifetime of an LED is far over 100'000 hours under normal operating conditions. Due to ERNI's high quality standard, ERNI's LED airfield lighting have a life cycle of far more than 6 years.

## Features

- Lens protected by ribs prevents from mechanical damage (ground handling vehicles and snow plow)
- fail-open function
- connection and Operation fully compatible with 2.8A to 6.6A airfield lighting series circuits
- fully dimmable
- extremely reduced maintenance due to:
  - LED technology
  - seal tight housing concept (protection grade IP 68)
- saturated LED colors, no filters required
- interchangeable top parts with ERNI light fixtures series IL 254R
- low energy consumption: approx. 21 to 26 Watt
- lifetime of LED: approx. 100'000 hours under average operating conditions
- built-in surge protection
- conducted and radiated emission as per CE EMC regulations
- elevation above ground 10 mm
- connection cable length 30 cm, L-823 with vulcanised plug

## Vertical cut – TEL application – omnidirectional characteristic

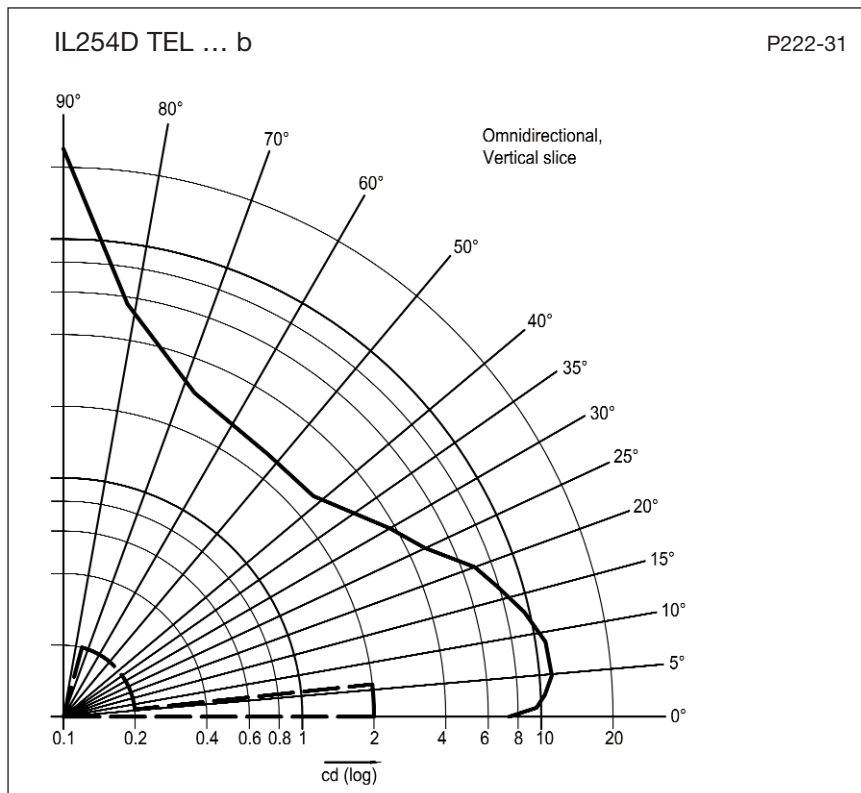

## Vertical cut – AGM application – omnidirectional characteristic

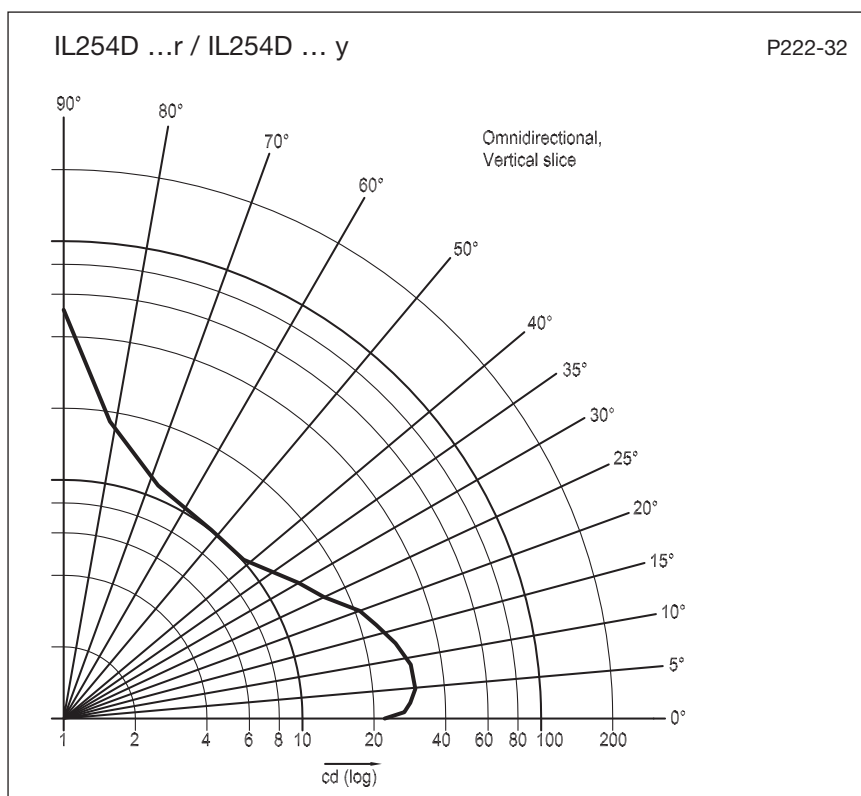

## Dimensions / Weights

Lamp housing of series IL 254D with two or four screws fit into 8" substructures.

**Option:** Use of a 12"/8" adapter ring in any substructure according to FAA AC 150/5345-42C, type L-868 B (12").

Article	Weight	Packing (cardboard box)
IL 254D	3,2 kg	203 x 203 x 112 mm

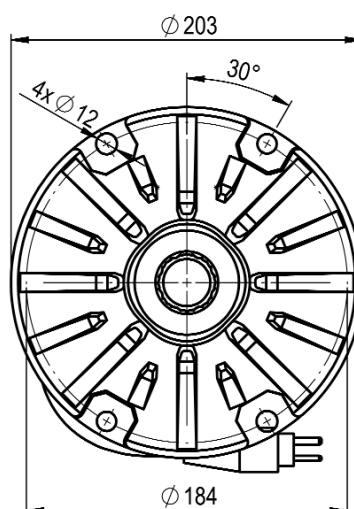
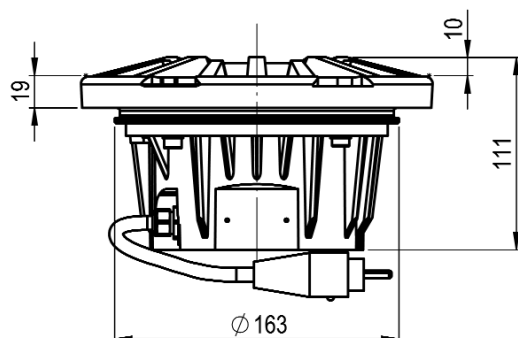

P242A

## Options

- without fail open device

## Accessories

Accessories must be ordered separately. For details see also section «mounting Systems». Substructures and series transformers to be ordered separately.

Subject to change

ERNI Licht-Technik AG, Zürichstrasse 72, CH-8306 Brüttisellen, Switzerland  
Phone +41 (0)44 835 33 43, Fax +41 (0)44 835 33 42

[info@erniairlight.com](mailto:info@erniairlight.com)



[www.erniairlight.com](http://www.erniairlight.com)