

TAXIWAY / APRON

Elevated Light – Low Intensity – Omnidirectional

EL 220



EL 224-TEL

Taxiway Edge
Apron Edge

Features

- sturdy, tight housing (IP67)
- compact dimensions and light weight
- optimal light performance with long lamp life due to excellent heat dissipation and seal tight concept
- no optical re-adjustments after maintenance operations
- smooth outer glass surface allows easy cleaning; no internal cleaning required
- quick-release locking device
- through-colored glass dome
- suitable for frangible pedestal, type ERNI STF-N30
- suitable for frangible and adjustable pedestal, type ERNI STR-N30
- standard length of connecting cable is 30 cm. Other dimensions are available as per customer specific requirements

General

The lights of Series EL 224 meet the guidelines of ICAO Annex 14 as well as Part 4 of the Aerodrome Design Manuals and are in compliance with IEC 61827. They are suitable for apron and taxiway applications. Transmittance of the blue glass dome is 3%. The light fixture is available either with a 45W/6.6A G6.35 halogen lamp or with a 45W/6.6A PK30d halogen lamp. Life expectancy of these halogen lamps is approximately 5'000 hours under average operating conditions.

Light characteristics and performance

Ordering color code and light transmittance

<input type="checkbox"/> w = white	100 %
<input checked="" type="checkbox"/> b = blue	3 %
<input checked="" type="checkbox"/> g = green	20 %
<input checked="" type="checkbox"/> y = yellow	50 %
<input checked="" type="checkbox"/> r = red	20 %
<input type="checkbox"/> s = blind	0 %

Main beam light distribution

Light type/ Application area	Halogen lamps PK30d, 6.6 A 1'000 hrs nom.*	Halogen lamps G6.35 1'000 hrs nom.*	Average light intensity	Light colour
EL 224-TEL Taxiway Edge Apron Edge	optional 45W	45W	ERNI hor 360° vert. 0-6° 3,5 cd vert. 0-30° 2,3 cd	blue

*Life expectancy: > 5'000 hrs using mixed intensity steps

Dimensions/Weights

Article	Weight	Packing (cardboard box)
Light EL 224	1,6 kg	155 x 145 x 190 mm
Pedestal STF-N30	0,2 kg	100 x 100 x 100 mm
Pedestal STR-N30	0,7 kg	150 x 150 x 170 mm
Base plate	2,4 kg	315 x 315 x 60 mm

Options

- electronic cut-out device
- unidirectional light beam
- yellow painted housing

Accessories

Accessories must be ordered separately. For details see also section «mounting systems».

Subject to change

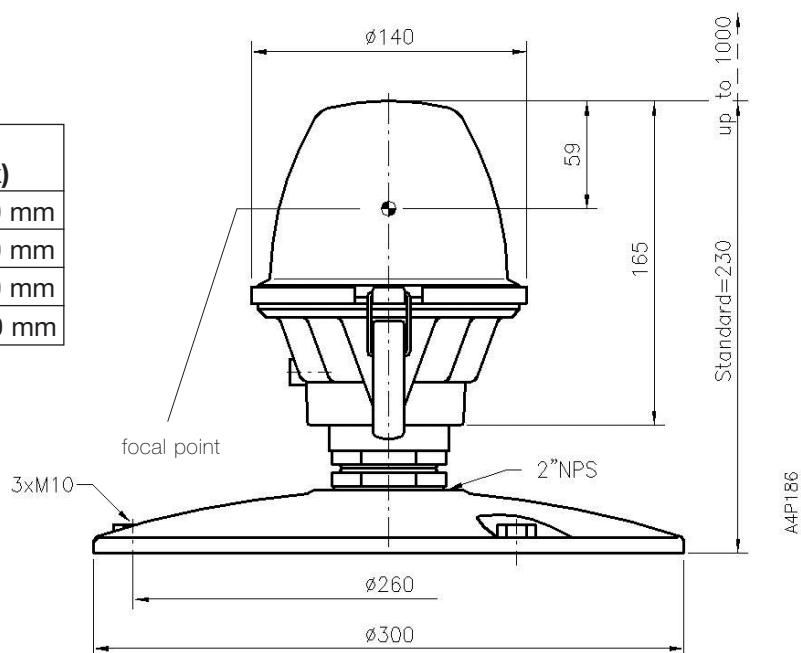

Vertical light distribution and light performance for an EL 224 TEL-45W-b with blue glass dome is vertically 0-30° with 2,3 cd light intensity.